

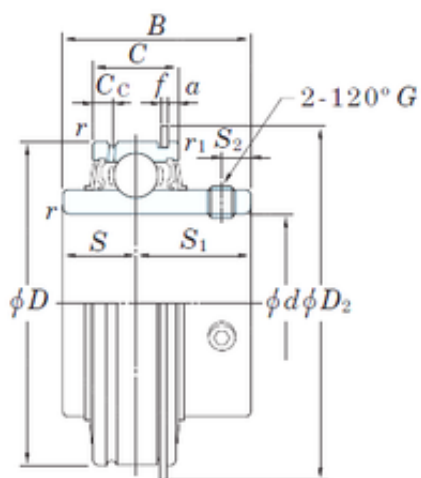

ISO BEARING-SINGAPORE (PTE)LTD.



61,9125 mm x 110 mm x 65,1 mm KOYO
ER212-39 deep groove ball bearings

Bearing No. ER212-39

Size	61.9125x110x65.1 mm
Bore Diameter	61,9125 mm
Outer Diameter	110 mm
Width	65,1 mm
d	61,9125 mm
D	110 mm
B	65,1 mm
C	32 mm
S1	39,7 mm
a	3,18 mm
f	2,41 mm
r min.	1,5 mm
r1 min.	0,5 mm
C	7,5 mm
D2	116,4 mm
S	25,4 mm
S2	10,5 mm
Thread (G) - 3/8-24UNF	3/824UNF
Weight	1,8 Kg
Basic dynamic load rating (C)	52,4 kN
Basic static load rating (C0)	36,2 kN

ER212-39 Bearing 2D drawings and 3D CAD models