

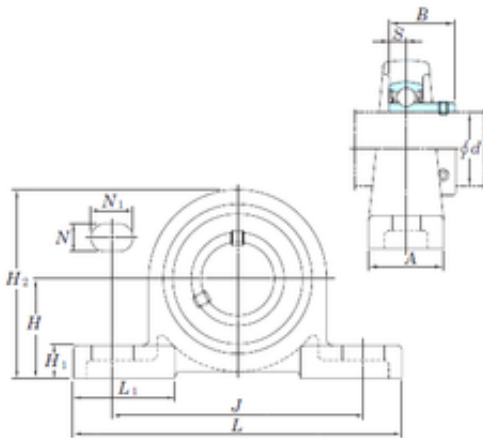

ISO BEARING-SINGAPORE (PTE)LTD.

KOYO BLP206-20 bearing units

Bearing No. BLP206-20



BLP206-20 Bearing 2D drawings and 3D CAD models

| | |
|-------------------------------|----------|
| Bore Diameter | 31.75 mm |
| Width | 30 mm |
| d | 31.75 mm |
| A | 33 mm |
| B | 30 mm |
| H | 42,9 mm |
| H1 | 14 mm |
| H2 | 83 mm |
| J | 120 mm |
| L | 156 mm |
| L1 | 47 mm |
| N | 14 mm |
| N1 | 21 mm |
| S | 8 mm |
| Bolt (G) | M12 |
| Weight | 0,69 Kg |
| Basic dynamic load rating (C) | 19,5 kN |
| Basic static load rating (C0) | 11,3 kN |