

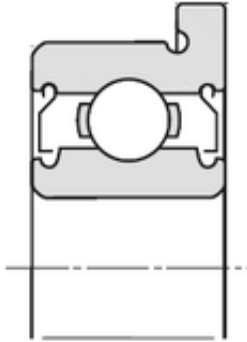

ISO BEARING-SINGAPORE (PTE)LTD.

9,000 mm x 17,000 mm x 4,000 mm NTN F-689
deep groove ball bearings



Bearing No. F-689

Size	9x17x4 mm
Bore Diameter	9,000 mm
Outer Diameter	17,000 mm
Width	4,000 mm
d	9,000 mm
D	17,000 mm
B	4,000 mm
C	4,000 mm

F-689 Bearing 2D drawings and 3D CAD models